

TECHNOLOGY

**HOLYKELL®**

**E**

L603-E

45°



IP68

OEM

...



E						
0-1 ...200						
$\leq \pm 0.5\%F.S( ) \leq \pm 0.25\%F.S( )$						
4~20mA	1~5V/0~5V	0~10 V	0.5~4.5V	SDI-12	RS485 Modbus RTU	
10~30V DC	8~30V DC	15~36V DC	5V DC 5%	12V DC	10~30V DC	
-30 ~70						
-40 ~85						
0~50						
304 316L						
IP68						
0.05%FS/ $\leq 100kPa$ , 0.04%FS/ $> 100kPa$						
0.2%F.S $\pm 0.05\%$						
150%F.S						
Exia II CT6						

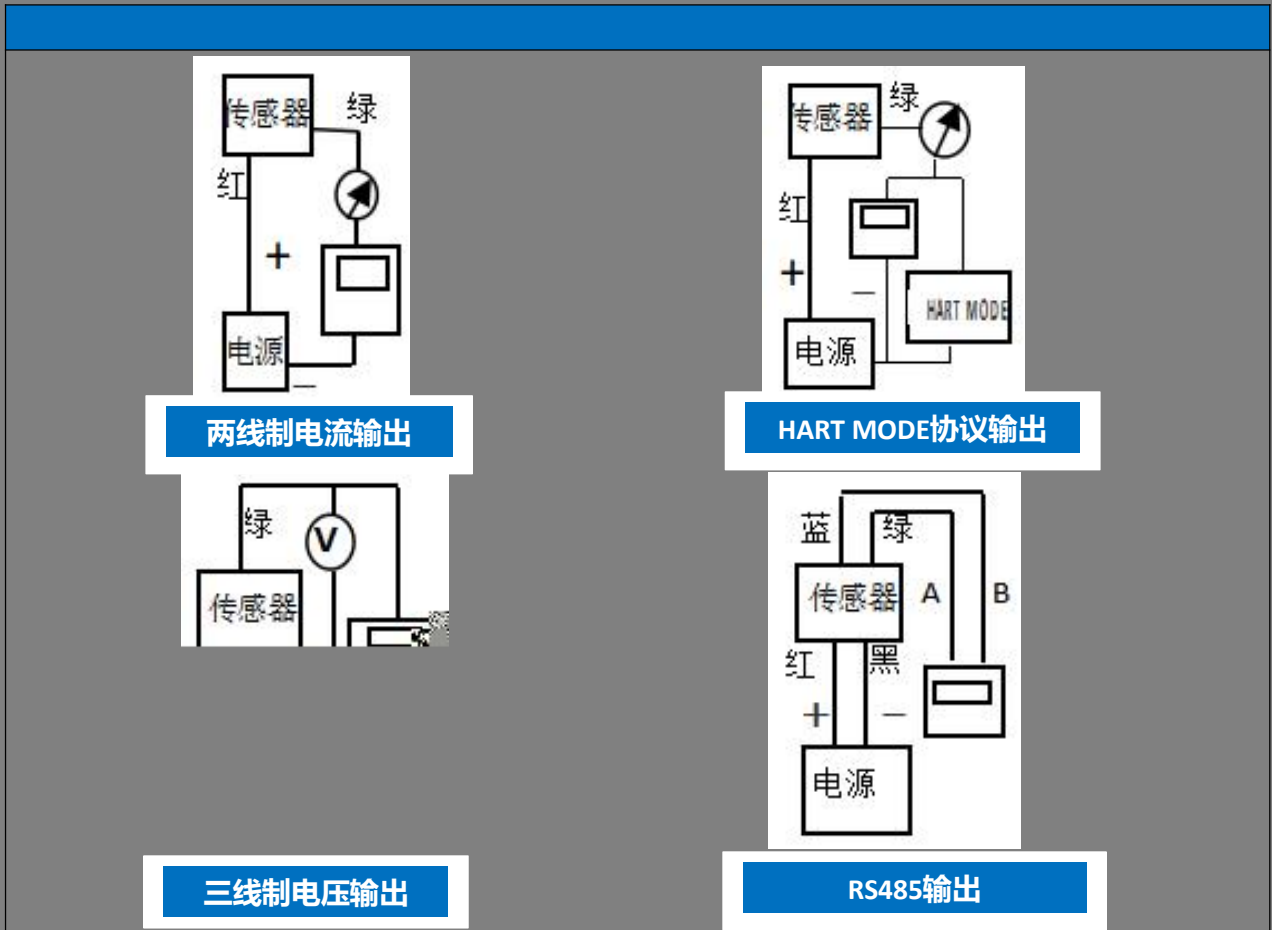
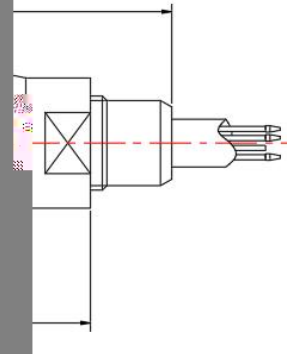

603-E

0-1...200