

ME600

0

ME600

-40 ~+135

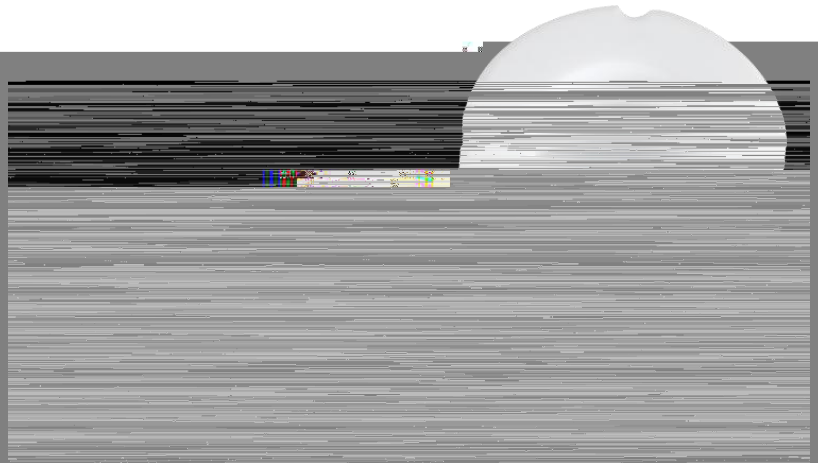

...

_____ (25)

ME600											
	(G)										
	2...30 VDC										
	-40 ...+135										
	-40 ...+150										
	Al2O3 96%										
	≤ 5g()										
	≤1.3@10V mA										
	≤1ms										
	11±30% kΩ										
	REACH, RoHS, Conflict Minerals Free										
(bar)	2	5	10	20	50	100	200	250	400	600	
(bar)	4	10	20	40	100	200	300	375	500	750	
(bar)	8	20	35	60	140	300	400	500	650	900	
(mm)	9.7	9.7	9.7	9.7	9.7	5.6	5.6	5.6	5.6	5.6	
(mV/V)	1.8...3.4	2.0...3.5	2.4...4.0	2.8...4.2	2.7...4.0	2.0...3.2	1.8...3.3	1.5...3.0	1.5...3.0	1.5...2.5	
(/)(%FS)	0.15/0.5	0.15/0.30	0.15/0.30	0.15/0.30	0.25/0.60	0.50/1.00	0.50/1.00	0.50/1.00	0.60/1.20	0.60/1.20	
(/)(%FS/K)	±0.025/±0.05 ±0.005/±0.02			+25 ...+85 +25 ...+85							
(%FS/K)	- 0.030()		-0.016%()		0()		-40 ...+135				

2.54mm

1.27mm

1.90mm

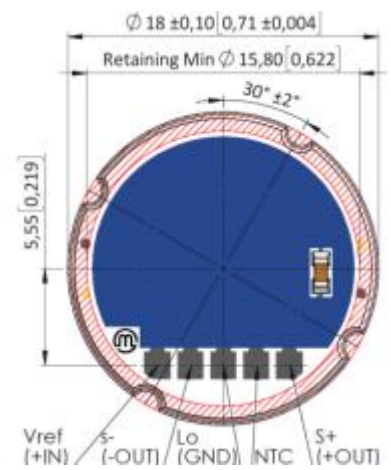
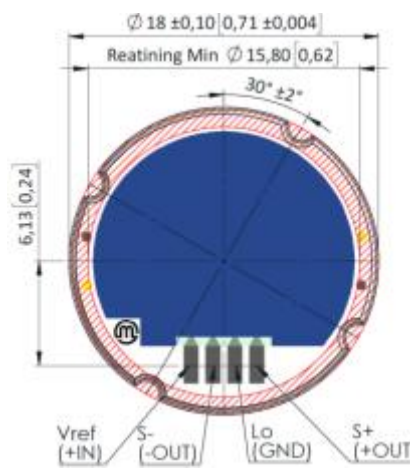
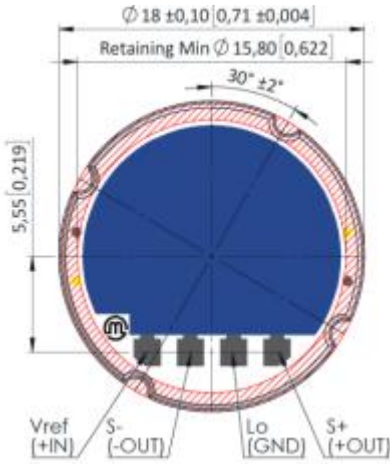

2.54mm	1.60 x 1.60 [0.063 x 0.063]
1.27mm	0.87 x 2.00 [0.034 x 0.079]
1.90mm	1.50 x 1.60 [0.059 x 0.063]

<100bar

100bar

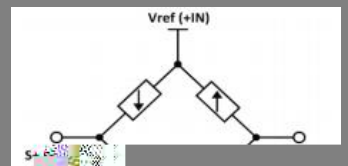
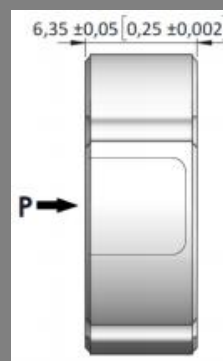
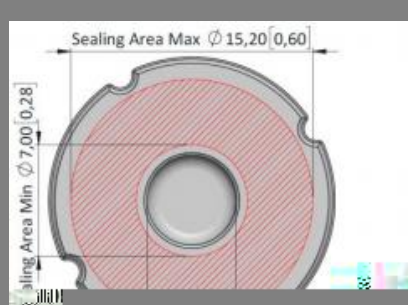
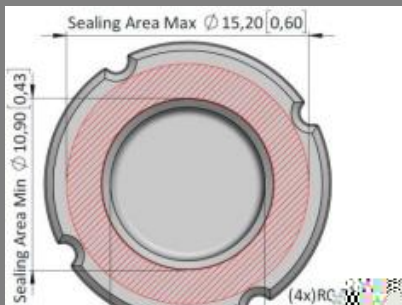

- Type 1 NTC SMD 10 k ± 1% = 3435 K
- Type 2 PT100 SMD 100 +3850 ppm/K F0.3 0.1
- Type 9

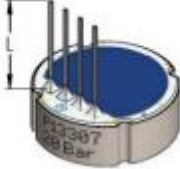
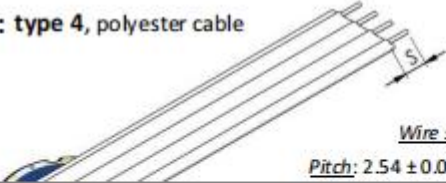
<p>举例 : type 0, pre-tinned soldering pads</p>  <p><u>Pitch:</u> 2.54 ± 0.05 [0.1 ± 0.002] <u>Maximum tin thickness:</u> 0.3 [0.01] <u>Op. Temp:</u> -40°C...+135°C (-40 °F...275 °F)</p>	<p>举例 : type 2, pins L = 13,0 ± 0,5 [0,35 ± 0,02]</p>  <p><u>Pitch:</u> 2.54 ± 0.05 [0.1 ± 0.002] <u>Pin section:</u> 0.51×0.25 [0.02×0.01] <u>Pin length:</u> $L = 9.0 \pm 0.5$ [0.35 ± 0.02] <u>Op./St. Temp:</u> -40°C...+135°C (-40 °F...275 °F)</p>
<p>举例 : type 4, polyester cable</p>  <p><u>Wire section:</u> AWG24 <u>Pitch:</u> 2.54 ± 0.05 [0.1 ± 0.002]</p>	<p>其它类型可选 :</p> <p>Type 1, pins L = 9 ± 0.5 [0.51 ± 0.02] (only for pitch 2.54 mm) Type 3, silicon single wire, 50.8 mm, Op./St. Temp: -20°C...+135°C Type 5*, pins L = 9 ± 0.5 [0.51 ± 0.02]</p>

600

1=0... 2 bar 2=0... 5 bar 3=0... 10 bar 4=0... 20 bar 5=0... 50 bar
 6=0... 100bar 7=0... 200bar 8=0... 250 bar 9=0... 400bar 10=0... 600 bar X=

0=-0.1± 0.1 mV/V 1=0.0 ± 0.1 mV/V
 2=+0.1± 0.1 mV/V X=

0= [TC0 ± 0.05 %FS/K] 1= [TC0 ± 0.02 %FS/K]
 2= [TC0 ± 0.01 %FS/K] X=

0=
 1=NTC SMD [RES0635- NTC 10K 1% 0603 3435K]
 2=PT100 SMD [RES1058 -PTS0603 + 3850ppm/K F0.3]
 X=

0=Pre-tinned pads [2.54/1.90/1.27]
 1=Pins-9mm [2.54/1.90/-]
 2=Pins-13mm [2.54/-/-]
 3=Silicone single wires 52 mm [2.54/1.90/1.27]
 4=POLYESTER Flat Cable 50.8 mm [2.54/-/-]
 5=PVC Flat Cable 50.8 mm [2.54/1.90/1.27]
 6=NOMEX™ cable 50.8 mm [2.54/1.90/-]
 X=

0=2.54mm 1=1.90mm 2=1.27mm X=

600 1 0 0 0 1 1